

SUBDIVISION 9290

PHASE 1

A ONE LOT SUBDIVISION FOR CONDOMINIUM PURPOSES

BEING A SUBDIVISION OF A PORTION OF PARCEL D
AS SHOWN ON PARCEL MAP MS 476-00, FILED
OCTOBER 12, 2000, IN BOOK 179 OF PARCEL
MAPS, PAGE 38, CONTRA COSTA COUNTY RECORDS

CITY OF HERCULES CONTRA COSTA COUNTY CALIFORNIA
DATED: JUNE 2017



OWNER'S STATEMENT:

THE UNDERSIGNED, BEING THE ONLY PARTY HAVING A RECORD TITLE INTEREST IN THE LAND DELINEATED AND EMBRACED WITHIN THE HEAVY BLACK BOUNDARY LINES UPON THIS MAP, DOES HEREBY CONSENT TO THE MAKING AND RECORDATION OF THE SAME.

THIS MAP SHOWS ALL EASEMENTS ON THE PREMISES, OR OF RECORD, AS DISCLOSED IN THE PRELIMINARY TITLE REPORT PREPARED BY FIRST AMERICAN TITLE COMPANY, ORDER NUMBER 0192-5408130, DATED MARCH 6, 2017.

IN WITNESS THEREOF, I HAVE CAUSED THIS STATEMENT TO BE EXECUTED THE DATE HEREUNDER WRITTEN.

OWNER: HERCULES DEVELOPMENT PARTNERS LP,
A DELAWARE LIMITED PARTNERSHIP

BY: HERCULES DEVELOPMENTS INC.,
A DELAWARE CORPORATION
ITS GENERAL PARTNER

BY: Patrick B. Patterson DATED: June 15, 2017
NAME: Patrick B. Patterson
TITLE: Gen. Vice President

OWNER'S ACKNOWLEDGMENT:

A NOTARY PUBLIC OR OTHER OFFICER COMPLETING THIS CERTIFICATE VERIFIES ONLY THE IDENTITY OF THE INDIVIDUAL WHO SIGNED THE DOCUMENT TO WHICH THIS CERTIFICATE IS ATTACHED, AND NOT THE TRUTHFULNESS, ACCURACY, OR VALIDITY OF THAT DOCUMENT.

STATE OF CALIFORNIA }
COUNTY OF ORANGE } S.S.

ON June 15, 2017, 2017, BEFORE ME Nicole Amaya, A NOTARY PUBLIC, PERSONALLY APPEARED PATRICK PATTERSON WHO PROVED TO ME ON THE BASIS OF SATISFACTORY EVIDENCE TO BE THE PERSON(S) WHOSE NAME(S) IS/ARE SUBSCRIBED TO THE WITHIN INSTRUMENT AND ACKNOWLEDGED TO ME THAT HE/SHE/THEY EXECUTED THE SAME IN HIS/HER/ THEIR AUTHORIZED CAPACITY(IES) AND THAT BY HIS/HER/THEIR SIGNATURE(S) ON THE INSTRUMENT THE PERSON(S) OR THE ENTITY UPON BEHALF OF WHICH THE PERSON(S) ACTED, EXECUTED THE INSTRUMENT.

I CERTIFY UNDER PENALTY OF PERJURY UNDER THE LAWS OF THE STATE OF CALIFORNIA THAT THE FOREGOING PARAGRAPH IS TRUE AND CORRECT.

WITNESS MY HAND.

SIGNATURE: Nicole Amaya PRINTED NAME: Nicole Amaya
NOTARY PUBLIC IN AND FOR
SAID COUNTY AND STATE
PRINCIPAL COUNTY OF BUSINESS: ORANGE
MY COMMISSION EXPIRES: 12/25/2020
COMMISSION NUMBER OF NOTARY: 2177001

CITY PLANNING DIRECTOR'S STATEMENT:

I HEREBY STATE THAT THIS MAP GENERALLY CONFORMS TO THE VESTING TENTATIVE MAP 9290 APPROVED BY THE CITY COUNCIL OF THE CITY OF HERCULES, COUNTY OF CONTRA COSTA, STATE OF CALIFORNIA, ON March 13, 2012.

DATED: 6/19/2017

Holly P. Smyth
HOLLY P. SMYTH
PLANNING DIRECTOR
CITY OF HERCULES
STATE OF CALIFORNIA

CITY CLERK'S STATEMENT:

I, SHERRY KELLY, DEPUTY CITY CLERK AND EX-OFFICIO CLERK OF THE CITY COUNCIL OF THE CITY OF HERCULES, COUNTY OF CONTRA COSTA, OF CALIFORNIA, DO HEREBY STATE THAT THIS MAP, CONSISTING OF THREE (3) SHEETS AND ENTITLED, "SUBDIVISION 9290, PHASE 1, A ONE LOT SUBDIVISION CONDOMINIUM PURPOSES" WAS PRESENTED TO SAID CITY COUNCIL, AS PROVIDED BY LAW, AT A CITY COUNCIL MEETING HELD ON THE _____ DAY OF _____, 2017, AND THAT BY RESOLUTION NO. _____, SAID CITY COUNCIL DID THEREUPON APPROVE SAID MAP.

I FURTHER STATE THAT ALL BONDS REQUIRED BY LAW TO ACCOMPANY THE WITHIN FINAL MAP HAVE BEEN APPROVED BY THE CITY COUNCIL OF THE CITY OF HERCULES AND ARE FILED IN MY OFFICE.

IN WITNESS WHEREOF, I HAVE HEREUNTO SET MY HAND THIS _____ DAY OF _____, 2017.

SHERRY KELLY, DEPUTY CITY CLERK
CITY OF HERCULES
STATE OF CALIFORNIA

CLERK OF THE BOARD OF SUPERVISORS STATEMENT:

I STATE, AS CHECKED BELOW, THAT:

- [] A TAX BOND ASSURING PAYMENT OF ALL TAXES WHICH ARE NOW A LIEN, BUT NOT YET PAYABLE, HAS BEEN RECEIVED AND FILED WITH THE BOARD OF SUPERVISORS OF CONTRA COSTA COUNTY, STATE OF CALIFORNIA.
- [] ALL TAXES DUE HAVE BEEN PAID AS STATED BY THE COUNTY REDEMPTION OFFICER.

DATED: _____ DAVID TWA
CLERK OF THE BOARD OF SUPERVISORS AND
COUNTY ADMINISTRATOR OF THE COUNTY
CONTRA COSTA, STATE OF CALIFORNIA

BY: _____
DEPUTY CLERK

COUNTY RECORDER'S STATEMENT:

THE MAP ENTITLED "SUBDIVISION 9290, PHASE 1, A ONE LOT SUBDIVISION FOR CONDOMINIUM PURPOSES" IS HEREBY ACCEPTED FOR RECORDATION SHOWING A CLEAR TITLE AS SUBDIVISION GUARANTEE MADE BY FIRST AMERICAN TITLE COMPANY, CONTRA COSTA COUNTY, DATED THE _____ OF _____, 2017, AND AFTER EXAMINING THE SAME, I DEEM THAT SAID MAP COMPLIES IN ALL RESPECTS WITH THE PROVISIONS OF STATE LAWS AND LOCAL ORDINANCES GOVERNING THE FILING OF SUBDIVISION MAPS.

FILED THIS _____ DAY OF _____, 2017, AT _____ .M. IN BOOK _____ OF MAPS AT PAGES _____, AND _____, AT THE REQUEST OF FIRST AMERICAN TITLE COMPANY IN THE OFFICE OF THE COUNTY RECORDER OF THE COUNTY OF CONTRA COSTA, STATE OF CALIFORNIA.

FEE: \$ _____ JOSEPH E. CENCIAMILLA
COUNTY RECORDER IN AND FOR
THE COUNTY OF CONTRA COSTA,
STATE OF CALIFORNIA

BY: _____
DEPUTY COUNTY RECORDER

SURVEYOR'S STATEMENT:

THIS MAP WAS PREPARED BY ME OR UNDER MY DIRECTION AND IS BASED UPON A FIELD SURVEY IN CONFORMANCE WITH THE REQUIREMENTS OF THE SUBDIVISION MAP ACT AND LOCAL ORDINANCE AT THE REQUEST OF LEDCOR GROUP, IN FEBRUARY OF 2017. I HEREBY STATE THAT THIS MAP SUBSTANTIALLY CONFORMS TO THE CONDITIONALLY APPROVED TENTATIVE MAP, AND THAT THE SURVEY IS TRUE AND COMPLETE AS SHOWN AND THAT THE AREA IS 2.205 ACRES, MORE OR LESS.

I FURTHER STATE THAT THE MONUMENTS SHOWN HEREON OCCUPY THE POSITIONS INDICATED AND THAT SAID MONUMENTS ARE SUFFICIENT TO ENABLE THE SURVEY TO BE RETRACED. ALL BEARINGS OF THIS MAP ARE BASED ON THE CALIFORNIA COORDINATE SYSTEM, ZONE 3.

DATED: 6-15-2017

Alex Calder
ALEX M. CALDER, PLS NO. 8863

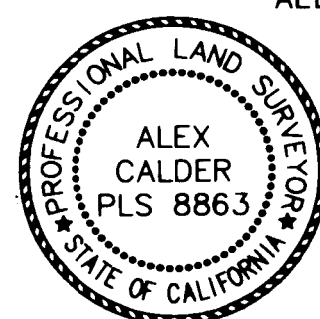

CITY ENGINEER'S STATEMENT:

I, MIKE ROBERTS, CITY ENGINEER OF THE CITY OF HERCULES, HEREBY STATE THAT I EXAMINED THIS FINAL MAP ENTITLED "SUBDIVISION 9290, PHASE 1, A ONE LOT SUBDIVISION FOR CONDOMINIUM PURPOSES"; THAT SAID SUBDIVISION AS SHOWN IS SUBSTANTIALLY THE SAME AS IT APPEARED ON THE TENTATIVE MAP AND ANY APPROVED ALTERATIONS THEREOF; AND THAT ALL THE PROVISIONS OF CHAPTER TWO OF THE CALIFORNIA SUBDIVISION MAP ACT AND LOCAL ORDINANCES GOVERNING THE FILING OF SUBDIVISION MAPS APPLICABLE AT THE TIME OF APPROVAL OF THE TENTATIVE MAP HAVE BEEN COMPLIED WITH.

DATED: 6-20-17

Michael Roberts
MIKE ROBERTS, CITY ENGINEER
R.C.E. 50426

CITY SURVEYOR'S STATEMENT:

I, VINCENT H. CUNHA, HEREBY STATE THAT THE MAP OF THIS SUBDIVISION WAS EXAMINED BY ME OR UNDER MY DIRECTION ON BEHALF OF THE CITY OF HERCULES AND I AM SATISFIED THAT SAID MAP IS TECHNICALLY CORRECT.

DATED: 6.21.17

Vincent H. Cunha
VINCENT H. CUNHA, CITY SURVEYOR
PLS NO. 4520

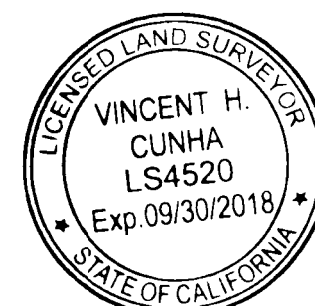

STATEMENT OF SOILS REPORT:

A SOILS AND GEOTECHNICAL INVESTIGATION REPORT FOR HERCULES BAYFRONT DEVELOPMENT, BLOCK N, HERCULES, CALIFORNIA, FOR LEDCOR GROUP, DATED FEBRUARY 28, 2017, WAS PREPARED BY ENGEO INCORPORATED, PROJECT NO. 4637.002.000, AND IS ON FILE WITH THE CITY OF HERCULES.

SUBDIVISION 9290

PHASE 1

A ONE LOT SUBDIVISION FOR CONDOMINIUM PURPOSES

BEING A SUBDIVISION OF A PORTION OF PARCEL D
AS SHOWN ON PARCEL MAP MS 476-00, FILED
OCTOBER 12, 2000, IN BOOK 179 OF PARCEL
MAPS, PAGE 38, CONTRA COSTA COUNTY RECORDS

CITY OF HERCULES CONTRA COSTA COUNTY CALIFORNIA
DATED: JUNE 2017



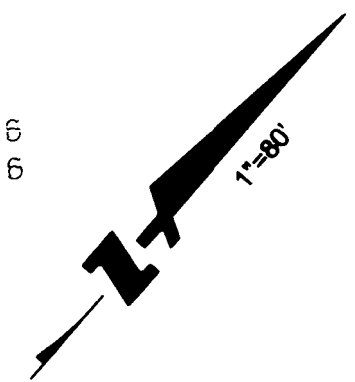
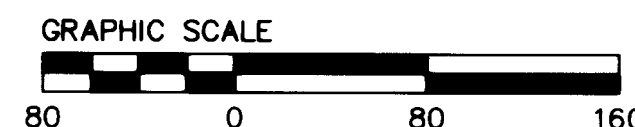

SUBDIVISION 9290

PHASE 1

A ONE LOT SUBDIVISION FOR CONDOMINIUM PURPOSES

BEING A SUBDIVISION OF A PORTION OF PARCEL D
AS SHOWN ON PARCEL MAP MS 476-00, FILED
OCTOBER 12, 2000, IN BOOK 179 OF PARCEL
MAPS, PAGE 38, CONTRA COSTA COUNTY RECORDS

CITY OF HERCULES CONTRA COSTA COUNTY CALIFORNIA
DATED: JUNE 2017 SCALE: 1" = 80'

BKF 100+
YEARS
ENGINEERS . SURVEYORS . PLANNERS
1646 NORTH CALIFORNIA BOULEVARD, SUITE 400
WALNUT CREEK, CA 94596

BASIS OF BEARINGS:

THE MONUMENT LINE OF BAYFRONT BOULEVARD, AS SHOWN ON THE MAP OF SUBDIVISION 8407, HERCULES VILLAGE, FILED DECEMBER 19, 2001, IN BOOK 437 OF MAPS AT PAGE 31, CONTRA COSTA COUNTY RECORDS, TAKEN AS NORTH 71°00'00" EAST. DISTANCES SHOWN ARE GROUND DISTANCES TO OBTAIN GRID DISTANCES MULTIPLY DISTANCES BY 0.999931. BEARINGS SHOWN HEREON CONFORM WITH CALIFORNIA COORDINATE SYSTEM, ZONE 3.

LEGEND:

- DISTINCTIVE BORDER OF LANDS BEING SUBDIVIDED
- - - - - EXISTING EASEMENT LINE
- ==== EXISTING RIGHT OF WAY OR PARCEL LINES
- _____ CENTER LINE
- _____ MONUMENT LINE
- FOUND STANDARD CITY MONUMENT
- C1 CURVE TABLE NUMBER
- M MAPS
- M-M MONUMENT TO MONUMENT
- M-ML MONUMENT TO MONUMENT LINE
- L1 LINE TABLE NUMBER
- O.R. OFFICIAL RECORDS
- PM PARCEL MAP
- R/W RIGHT OF WAY
- SUBD SUBDIVISION
- SFNF SEARCHED FOR, NOT FOUND
- () DENOTES RECORD DATA
- (1) DENOTES MAP REFERENCE NUMBER

LINE TABLE

NO.	BEARING	DISTANCE
L1	N 89°16'01" W	26.42' (2)
L2	N 00°43'59" E	11.50' (2)
L3	N 19°00'00" W	48.57' (2)
L4	N 71°00'00" E	30.26' (2)

CURVE TABLE

NO.	DELTA	RADIUS	LENGTH
C1	11°20'17"	256.00'	50.66' (2)
C2	02°24'04"	367.00'	15.38' (2)

MAP REFERENCE:

- (1) SUBDIVISION 8407, 437 M 31-42
- (2) 2012-178483 O.R.
- (3) SUBDIVISION 8599, 456 M 42-47

NOTE:

DISTANCES AND DIMENSIONS ARE IN FEET AND DECIMALS THEREOF.

